

Broadland Memories

www.broadlandmemories.co.uk

“Wayfarer” & “Just Jane”

Ken Harrison, a Naval Architect and Surveyor, was asked to design three wooden motor cruisers for Richardsons boatyard, then based in Oulton Broad, which were built between the years of 1947 and 1951. Ken has kindly allowed me to publish some of his original drawings and plans for those cruisers on Broadland Memories.

Ken Harrison 1947

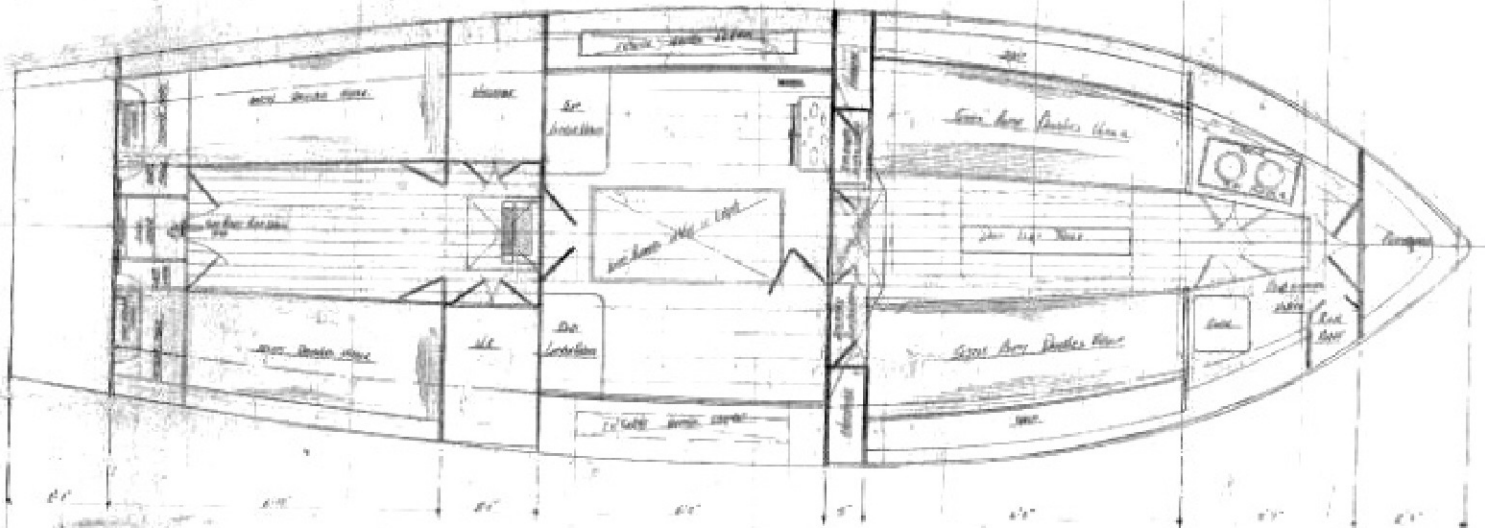
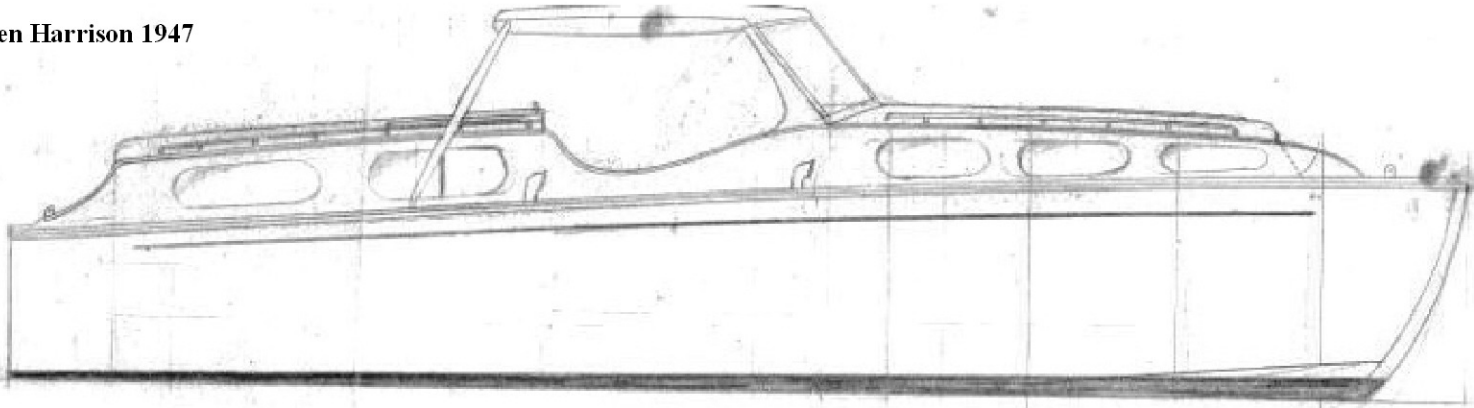

30' MOTOR CRUISER FOR ROBERT RICHARDSON

PROFILE AND ARRANGEMENT PLAN

"JUST JANE" AND "WAYFARER"

DESIGNED BY KEN HARRISON 1947-48

SCALE: 3/8" = 1"

JUST JANE & WAYFARER

R. Richardson, Oulton Broad

TO SLEEP

5



- Length.** 30ft.
- Beam.** 9ft. 8ins.
- Draught.** 2ft. 6ins.
- Headroom.** 6ft.
- Power.** 12/24 h.p. Morris "Navigator" marine engine with self-starter.
- Cooking.** Gas stove with oven in separate galley with sink.
- Lighting.** Electric.
- Berths.** Five single berths.

Other features. Two cabins separated by central cockpit which is fitted with a collapsible canopy, windscreen and side curtains. Ample drawer and locker accommodation. Flushing W.C. in separate compartment. Large freshwater tank. Dinghy provided.

